

# D171A

Threaded DZR Ball Valve



D171A

# D171AEXS

Threaded DZR Ball Valve with Extension Stem

PN25

### Features & Benefits

- Designed to be light, compact and easy to install and operate
- Features improved leak resistance and reduced risk of damage from over tightening
- WRAS Approved to 85°C
- Extension stem (EXS) to enable valve operation whilst the valve and associated pipework is surrounded with insulation or if the valve is in a hard to access area.
- Conforms to BS EN 13547

### Materials

PART	MATERIAL	QUANTITY
Hex-Nut	Steel Plated	1
Lever	Steel Dacromet Plated	1
Sleeve	Maroon PVC	1
Packing Nut	Brass BS EN 12164 CW617N	1
Packing Gland	PTFE WRAS approved	1
Body	DZR Brass BS EN 12165 CW602N	1
Seats	PTFE WRAS approved	2
Ball (1/4 – 1")	DZR Brass Chrome Plated BS EN 12165 CW602N	1
Ball (1.1/4 – 2")	Stainless Steel 304 BS EN 10088-3 1.4301 / AISI 304	1
O-Ring	Rubber EPDM WRAS approved	1
Seat Retainer	DZR Brass BS EN 12165 CW602N	1
Stem	DZR Brass BS EN 12164 CW602N	1
Extension Stem Outer	Aluminium	1
Extension Stem Inner	Zinc Plated Steel	1

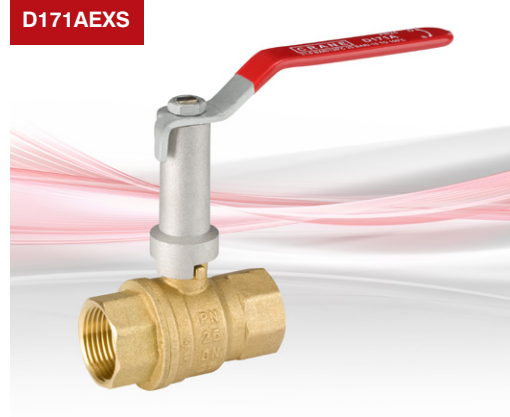
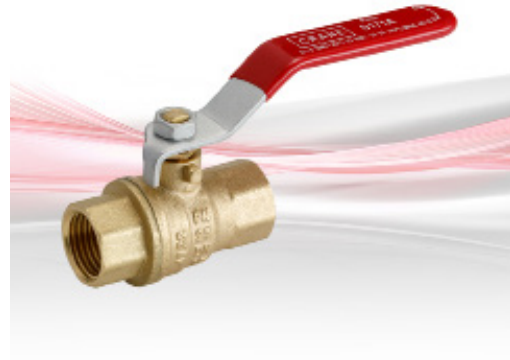

### Dimensional Drawing

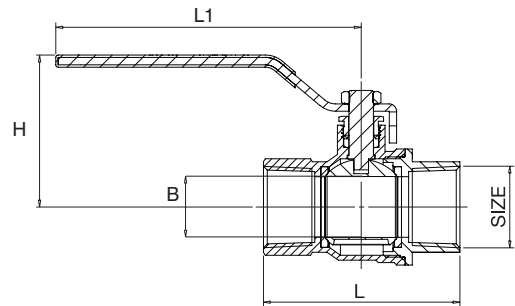

All dimensions are nominal.

### Dimensions & Weights

SIZE (inch)	WEIGHT (A) (kg)	WEIGHT (AEXS) (kg)	L (mm)	B (mm)	H (A) (mm)	H (AEXS) (mm)	L1 (mm)	KV
1/4	0.152	-	46	8.0	40.9	-	89	11
3/8	0.136	-	46	10.0	40.9	-	89	11
1/2	0.209	0.268	59	15.0	48.3	103.8	98.5	31
3/4	0.308	0.364	67	20.0	51.8	107.3	98.5	45
1	0.52	0.597	80.4	25.0	62.7	116.2	125	63
1-1/4	0.835	0.948	94	32.0	79	130	140	102
1-1/2	1.139	1.252	102	39.5	84.8	135.8	140	375
2	1.924	2.066	124	50	97.5	150	165	420

### Pressure/Temperature Ratings

#### Threaded

TEMPERATURE (°C)	-10 to 100	120
PRESSURE (BAR)	25	21.8

Intermediate pressure ratings shall be determined by interpolation.

**PRESSURE RATING:** PN25

**TEMPERATURE OPERATING RANGE:** -10 to 120°C

**UK END CONNECTION:** Taper threaded to BS EN 10226-2 (ISO 7-1) formerly BS 21

**US END CONNECTION:** ANSI B1.20.1:1983 (please add suffix AT to denote American Thread)

**OPERATOR:** Lever

**SPECIFICATION:** DZR Brass (CW602N) Body Ball Valve, in accordance to BS EN 13547, two-piece construction, Floating Chrome Plated DZR(CW602N) Ball/ Floating Stainless Steel Ball, Anti Blow-out stem, PTFE seats, Threaded Ends, PN25 Rated. Suitable for use on Group 2 Gas, Group 1 and Group 2 Liquids as defined by Pressure Equipment Directive 2014/68/EU, and Pressure Equipment (Safety) Regulations 2016, as amended.\* Not suitable for use on Group 1 Gases or unstable liquids.

Every effort has been made to ensure that the information contained in this publication is accurate at the time of publishing. Crane Ltd assumes no responsibility or liability for typographical errors or omissions or for any misinterpretation of the information within the publication and reserves the right to change without notice.

Valid as of 24/01/24