

F625

Fully-Lugged Gearbox Operated Butterfly Valves

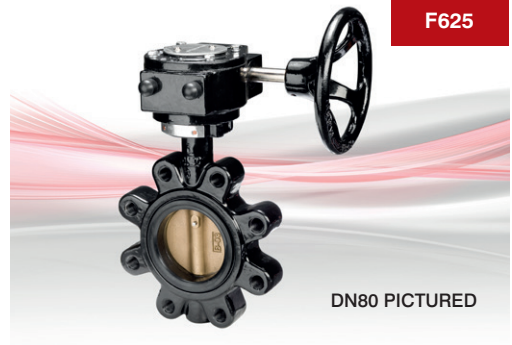

PN16



Features & Benefits

- WRAS Approved for potable water applications -10°C to 80°C
- Robust, ductile iron valve body for long life service
- Valve body fully-lugged for secure installation
- The anti-blow out stem design provides a safe and secure operation
- Fully bonded epoxy paint system for superior corrosion resistance
- Suitable for applications where Level 3 C3 (Medium) corrosion protection is required
- Maintenance free valve design, reducing downtime
- Suitable for a wide temperature range -10°C to 100°C

Materials

PART	MATERIAL
Body	Ductile Iron ASTM A536 65-45-12 / EN-GJS-450-10 (Epoxy Paint)
Disc	Aluminium Bronze
Liner	EPDM (WRAS Approved) Temp. -10 to 100°C (80°C WRAS)
Shaft	Stainless Steel Type 410
Taper Pin	Stainless Steel Type 316
O-Ring	Buna-N
Bushing	PTFE
Gearbox	Cast Iron

Dimensional Drawing

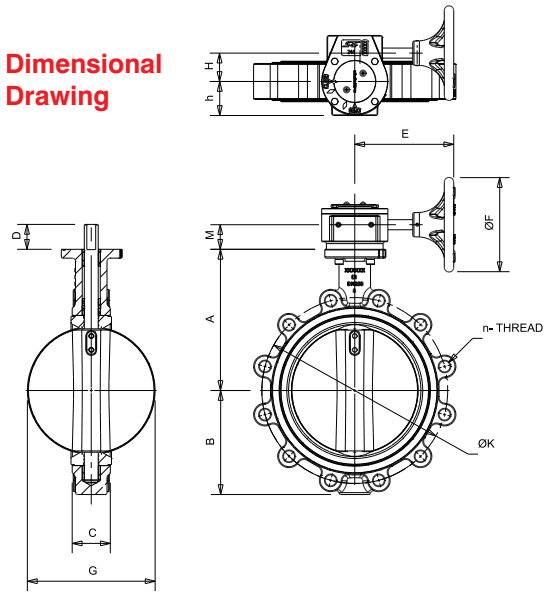

Pressure/Temperature Ratings

	F625
MAX TEMPERATURE (°C)	-10 to 100
PRESSURE (BAR)	16

Intermediate pressure ratings shall be determined by interpolation. WRAS approved -10 to 80 °C

Dimensions & Weights

SIZE (mm)	GEARBOX OPERATED		A (mm)	B (mm)	C (mm)	D (mm)	E (mm)	F (mm)	G (mm)	H (mm)	h (mm)	M (mm)	Kv	N- THREAD
	WEIGHT (kg)													
50	8.3		109	72	43	32	157	150	52.9	45	54	39	98	4- M16x2.0
65	8.7		131.5	82	46	32	157	150	64.6	45	54	39	167	4- M16x2.0
80	9.7		134	90	46	32	157	150	79	45	54	39	258	8- M16x2.0
100	11.2		163	108	52	32	157	150	104.4	45	54	39	512	8- M16x2.0
125	13.9		169	125	56	32	157	150	123.5	45	54	39	872	8- M16x2.0
150	15.8		179	142	56	40	157	150	155.8	45	54	39	1,347	8- M20x2.5
200	23.0		224	165	60	40	238	300	202.7	45	54	39	2,675	12- M20x2.5
250	44.9		264	215	68	40	238	300	250.7	63	81	41.5	4,555	12- M24x3.0
300	64.2		299	240	78	40	223.5	300	301.9	78	81	38.3	7,037	12- M24x3.0

*Kv coefficient denotes valves in fully open position

PRESSURE RATING: PN16

TEST PRESSURES:

Shell: 24 Bar Seat: 17.6 Bar

SPECIFICATION: Butterfly Valve, as per BS EN 593 / ASTM 609 A, Fully Lugged as per BS EN 558, Concentric design, EPDM liner, Fusion Bonded Epoxy paint, Gear operated. Ductile Iron Body, Al-Brz disc, SS shaft, PN16 rated, suitable to mount between EN 1092-2 PN16 flanges. WRAS Approved for potable water applications.

MEDIUM:

Suitable for Group 2 liquids as defined by the Pressure Equipment Directive 2014/68/EU* WRAS approved valves.

*see Quality Assurance page for more information

Valid as of 21/02/24

Every effort has been made to ensure that the information contained in this publication is accurate at the time of publishing. Crane Ltd assumes no responsibility or liability for typographical errors or omissions or for any misinterpretation of the information within the publication and reserves the right to change without notice.