

FA648G / FA644G / FA658G / FA654G / FA678G / FA674G

Fully Lugged Gearbox Operated Butterfly Valves

ANSI 125

FA648G



Features & Benefits

- Valves are suitable for use with flanges conforming to ANSI B16.1 Class 125
- Valve generally conforms to MSS SP 67
- Ductile Iron, Stainless Steel, Aluminium Bronze Disc Options
- EPDM and Nitrile Seat Liner Options
- 420 Stainless Steel Shafts for superior strength

Valve Selection

| | EPDM LINER | NITRILE LINER |
|-----------------------|------------|---------------|
| DUCTILE IRON DISC | FA648G | FA644G |
| STAINLESS STEEL DISC | FA658G | FA654G |
| ALUMINIUM BRONZE DISC | FA678G | FA674G |

Materials

| PART | MATERIAL |
|---------------------------------|---|
| Body | Ductile Iron (EN-GJS-400-15) |
| Disc (FA648G & FA644G) (6"-24") | Ductile Iron (EN-GJS-400-15) Epoxy Coated |
| Disc (FA658G & FA654G) (6"-24") | Stainless Steel 304 (ASTM A351 CF8) |
| Disc (FA678G & FA674G) (2"-4") | Aluminium Bronze (ASTM B148 C95400) |
| Liner (FA648G, FA658G & FA678G) | EPDM |
| Liner (FA644G, FA654G & FA674G) | Nitrile rubber |
| Shaft | Stainless Steel 420 (ASTM A276 420) |
| Taper Pin | Stainless Steel 431 (ASTM A276 431) |
| O-Ring | Nitrile rubber |
| Bushing | PTFE |

Dimensional Drawing

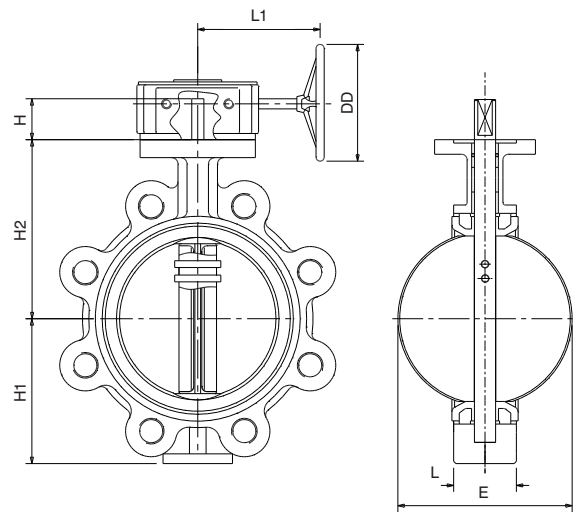

Dimensions & Weights

| SIZE (inch) | WEIGHT (kg) | | H2 | H1 | L | H | L1 | ØE | DD | Kv |
|-------------|-------------|---------|-----|-------|-----|----|-----|-------|-----|-------|
| | BARESHAF | GEARBOX | | | | | | | | |
| 2 | 3.0 | 7.9 | 141 | 61 | 43 | 32 | 157 | 52.9 | 145 | 133 |
| 2.5 | 3.4 | 8.3 | 153 | 72 | 46 | 32 | 157 | 64.7 | 145 | 227 |
| 3 | 4.7 | 9.6 | 161 | 87 | 46 | 32 | 157 | 79.1 | 145 | 349 |
| 4 | 6.6 | 11.5 | 179 | 106 | 52 | 32 | 157 | 104.4 | 145 | 694 |
| 5 | 9.1 | 14.0 | 193 | 123 | 56 | 32 | 157 | 123.3 | 145 | 1181 |
| 6 | 10.0 | 14.9 | 204 | 137 | 56 | 32 | 157 | 155.6 | 145 | 1825 |
| 8 | 17.4 | 26.2 | 247 | 174 | 60 | 45 | 236 | 202.5 | 300 | 2503 |
| 10 | 25.0 | 34.0 | 280 | 209 | 68 | 45 | 236 | 250.5 | 300 | 3876 |
| 12 | 34.0 | 46.0 | 324 | 253 | 78 | 45 | 237 | 301.6 | 300 | 6736 |
| 14 | 52.0 | 63.0 | 310 | 260 | 78 | 48 | 237 | 333.6 | 300 | 8135 |
| 16 | 81.0 | 106.0 | 340 | 317.5 | 102 | 64 | 246 | 389.5 | 300 | 12041 |
| 18 | 106.0 | 131.0 | 375 | 330 | 114 | 64 | 246 | 440.5 | 380 | 14121 |
| 20 | 140.0 | 170.0 | 425 | 367 | 127 | 64 | 254 | 489.7 | 285 | 18449 |
| 24 | 220.0 | 270.0 | 505 | 443 | 154 | 82 | 301 | 592.7 | 400 | 24125 |

Pressure/Temperature Ratings

| | FA648G/FA658G/FA678G | FA644G/FA654G/FA674G |
|------------------|----------------------|----------------------|
| TEMPERATURE (°C) | -10 to 120 | -10 to 82 |
| PRESSURE (BAR) | 15.3 | 15.3 |

PRESSURE RATING: ANSI 125

END CONNECTION: Fully Lugged

OPERATOR: Gearbox

OTHER: Bare shaft options available (Fig No. FA648B / FA658B / FA644B / FA654B / FA678B / FA674B)

Please contact us for bare shaft top works details

SPECIFICATION: End connections compatible with ANSI B16.1 Class 125 flanges.

TEST PRESSURES: (Hydrostatic)

SHELL: 24 bar

SEAT: 17.6 bar

Valid as of 08/12/20

Every effort has been made to ensure that the information contained in this publication is accurate at the time of publishing. Crane Ltd assumes no responsibility or liability for typographical errors or omissions or for any misinterpretation of the information within the publication and reserves the right to change without notice.