

# FM492

## Cast Iron Swing Check Valve

PN16

FM492



GENERAL VALVES

### Features & Benefits

- Check valves permit flow in one direction only and close automatically if flow reverses
- Swing Type Check Valve with Bronze seat
- Fusion Bonded Epoxy coating suitable for C3 environment

### Materials

PART	MATERIAL	SIZES
Body	Cast Iron BS EN 1561 GJL-250	All
Cap	Cast Iron BS EN 1561 GJL-250	All
Disc	Cast Iron BS EN 1561 GJL-250	All
Body Seat Ring	Bronze BS EN 1982 CC491K	All
Disc Ring	Bronze BS EN 1982 CC491K	All
Hinge Pin Bush	Bronze BS EN 1982 CC491K	All
Hinge Pin Plug	Bronze BS EN 1982 CC491K	All
Hinge Pin	Stainless Steel Type 304	50 - 100
Hinge Pin	13% Cr.Steel AISI Type 410	125 - 300
Cap Bolts	Steel BS 3692 Gr.8.8	All
Cap Bolt Nuts	Steel BS 3692 Gr.8	All
Gasket	Asbestos Free	All
Body Plate	Aluminium	All

### Dimensional Drawing

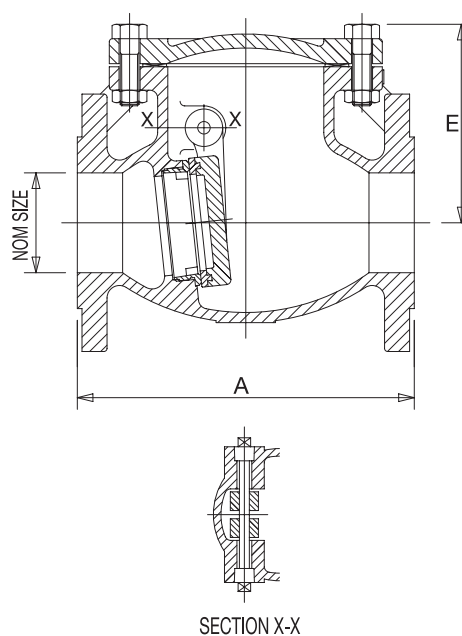

### Dimensions & Weights

SIZE (mm)	WEIGHT (kg)	A (mm)	E (mm)
50	11.3	203	113
65	15.6	216	126
80	19.3	241	136
100	26.6	292	153
125	44	330	186
150	55.5	356	207
200	119	495	250
250	175	622	352
300	263	698	397

### Pressure/Temperature Ratings

TEMPERATURE (°C)	-10 to 120	220
PRESSURE (BAR)	16	12.1

Intermediate pressure ratings shall be determined by interpolation.

**PRESSURE RATING:** PN16

**TEMPERATURE OPERATING RANGE:** -10 to 220°C

**UK END CONNECTION:** Flanged BS EN 1092-2

**OPERATOR:** Swing Type Check Valve

**SPECIFICATION:** Swing Type Check Valve in accordance with BS EN 16767, PN16 Rated. Cast Iron Body, Cap and Disc. CC491K Bronze Seat Ring, Disc Ring, Bush and Plug. SS Hinge pin, Asbestos free gasket. Fusion Bonded Epoxy coating suitable for C3 environment. The valve has been categorized in accordance with Pressure Equipment Directive 2014/68/EU as shown in below table.

FIG NO.	MATERIAL	PED CATEGORY BY VALVE SIZE (DN)			PRODUCT APPLICATIONS			
		SEP	1	2	Group 1 Gas	Group 2 Gas	Group 1 Liquid	Group 2 Liquid
FM492	Cast Iron	50	65-125	150-300	-	✓	✓	✓

\* See page 159 for more information